

8/17/99

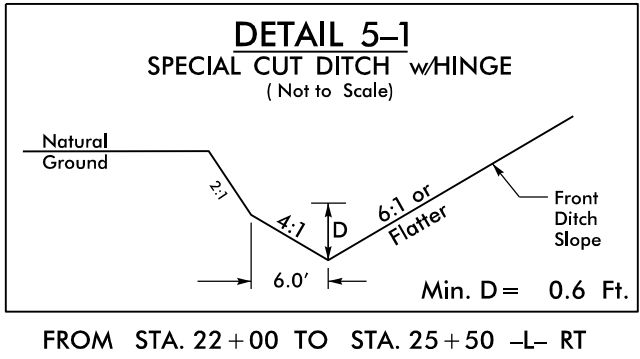

-L-  
PI Sta 31+06.43  
 $\Delta = 17^{\circ} 31' 22.7''$  (RT)  
 $D = 0^{\circ} 44' 55.4''$   
 $L = 2,340.37'$   
 $T = 1,179.39'$   
 $R = 7,652.44'$   
 $SE = EX$   
 $RO = EX$

NAD 83/2011

PROJECT REFERENCE NO. <b>W-5805G</b>		SHEET NO. <b>5</b>
RW SHEET NO.		
ROADWAY DESIGN ENGINEER 12/4/2025 NORTH CAROLINA PROFESSIONAL SEAL 053483 SPENCER W. MERITT	HYDRAULICS ENGINEER 12/4/2025 NORTH CAROLINA PROFESSIONAL SEAL 054713 HE YANG	
DOCUMENT NOT CONSIDERED FINAL UNLESS ALL SIGNATURES COMPLETED		
Prepared in the Office of: <b>SUMMIT</b> ENGINEERING AND CONSTRUCTION SERVICES	NC FIRM LICENSE No: P-0359 320 Executive Ct. Hillsborough, NC 27278 (919) 732-3883 (919) 732-6676 (FAX)	

REVISIONS

MATCHLINE -L- Sta. 15+50.00  
(SEE SHEET 4)

MATCHLINE -L- Sta. 28+50.00  
(SEE SHEET 6)

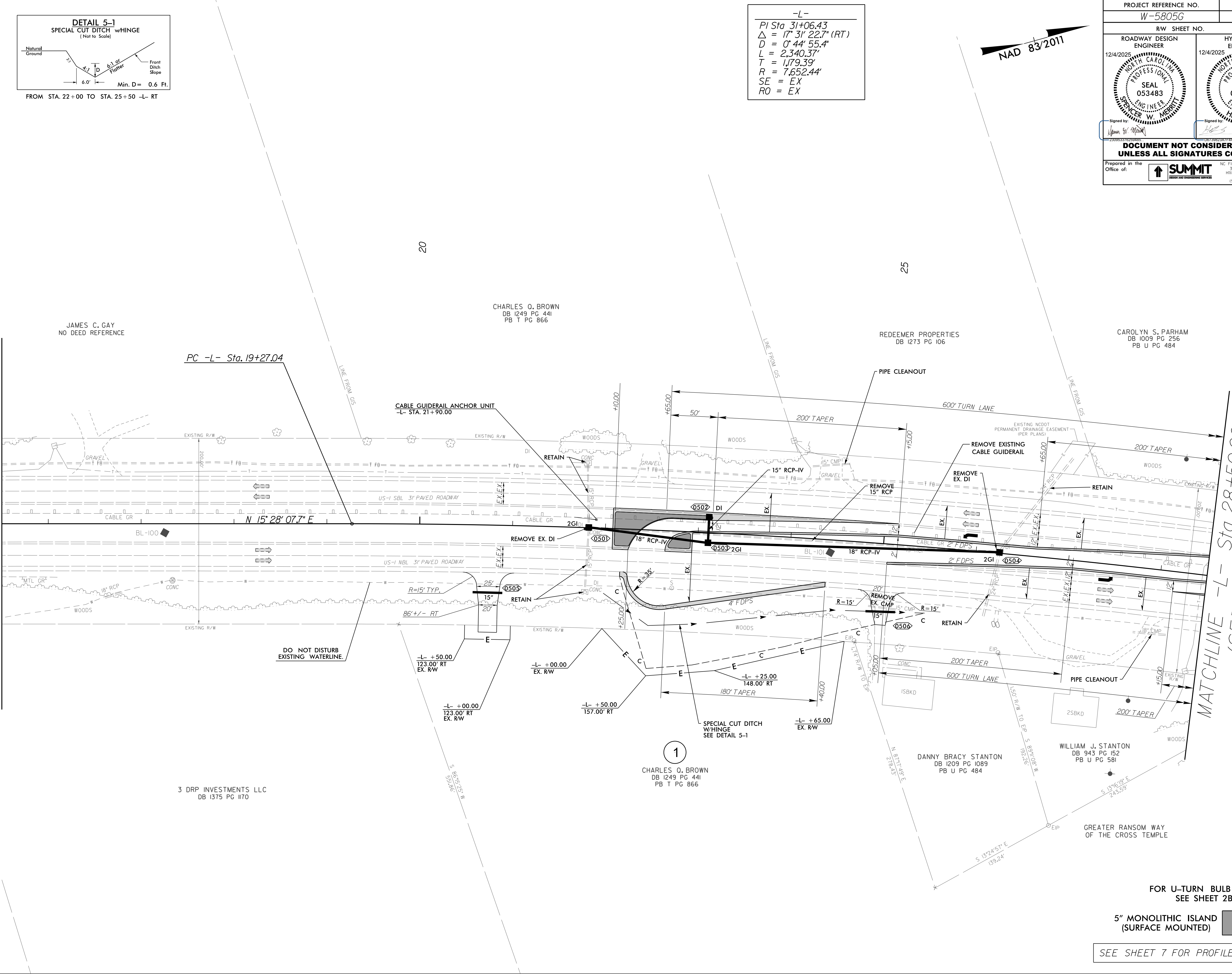

FOR U-TURN BULB DETAILS  
SEE SHEET 2B-2

5" MONOLITHIC ISLAND  
(SURFACE MOUNTED)

SEE SHEET 7 FOR PROFILE VIEW

18-NOV-2025 10:25  
W-5805G-P01-Part5.dgn  
zoe.zwick